



A Project By : **Pranali Infrastructure**



Incredible Living, Limitless Style

Pranali Infrastructure Presents



Luxurious

2&3 BHK Residential Apartment



Experience a Stunning Luxury





Amenities



- Ample Parking
- Solar Panel For Common Areas
- CCTV Camera
- Video Door Phone
- Three Track UPVC Windows
- Terrace Garden
- Children Play Area
- EV Charging Point
- All Room Flooring Size 1200x600

Amenities



Lobby Access Control System



Lift With Battery Backup



Video Door Phone



UPVC Window



Sky Court Is The
Happy Place
For Your Family



FLOOR PLAN



3BHK

1st To 7th FLOOR

FLOOR PLAN

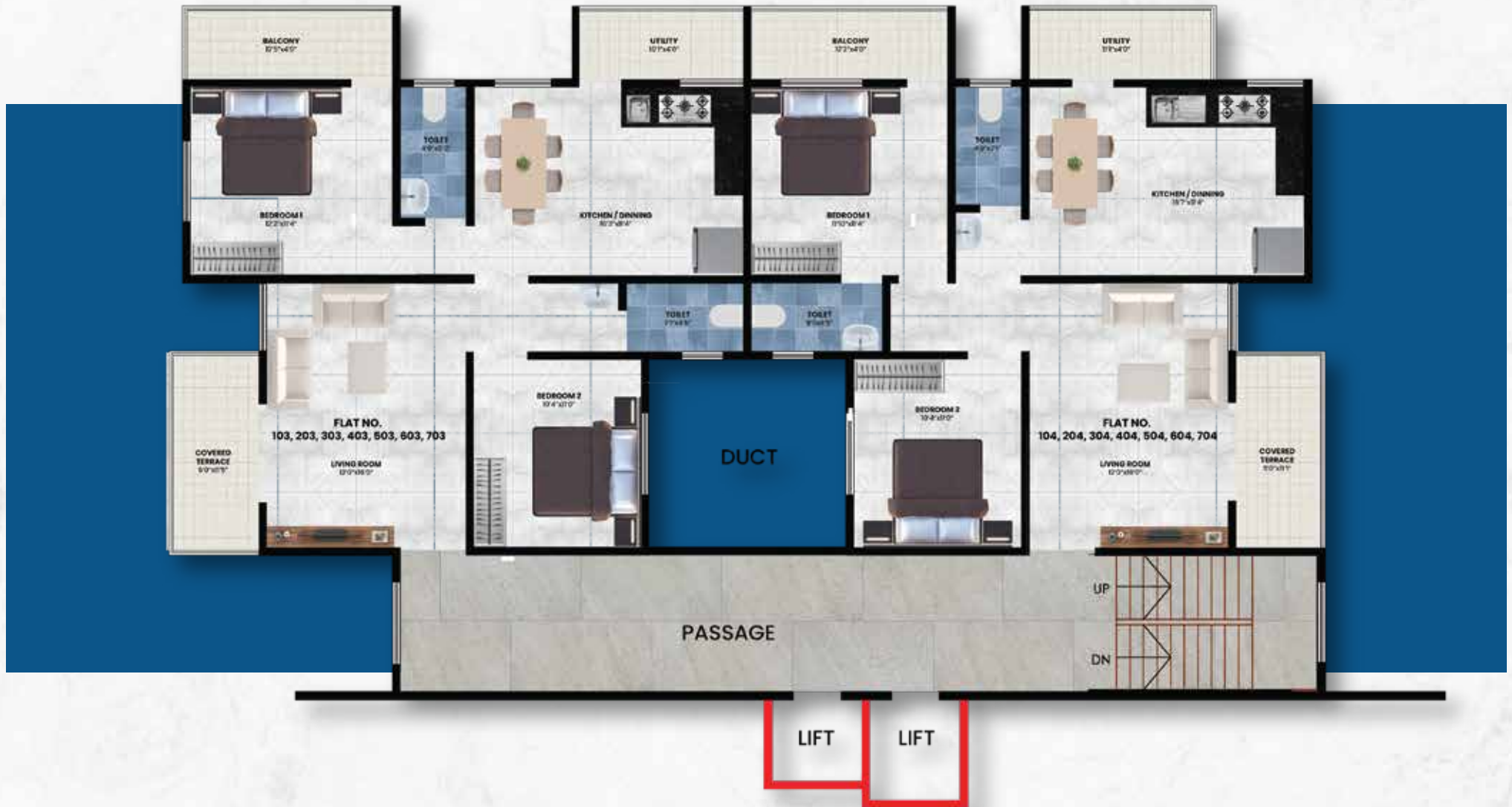

2BHK

1st To 7th FLOOR

CUT SECTION



3BHK

Sky Court offers the perfect combination of luxury comfort and quality in 2 BHK and 3 BHK flats, with excellent architecture and well planned designs.

CUT SECTION



2BHK

Sky Court offers the perfect combination of luxury comfort and quality in 2 BHK and 3 BHK flats, with excellent architecture and well planned designs.

TERRACE GARDEN



GROUND FLOOR GARDEN



Project By



Mahalaxmi
Garden

Balikashram Rd

Ahilya Nagar - Manmad Rd

Kankariya
Mall.

Kohinoor
Mall.

Noble
Hospital

Dominos

Project Credits

Engineer	: Anil Patil
Architect	: Vaibhav Deshmukh
RCC Consultant	: Vivek Apte
Legal Advisor	: R.T. Sharma
Landscape Architect	: Mayuresh Deshmukh

Contact

Er. Anil Patil : 93252 29109
Avinash Bhosale : 98223 08930

Office : Sky Hub 501, Aikyanagar,
Opp to Yashodanagar, Pipeline Road,
Savedi , Ahilyanagar

Office No. : +91 89 8282 7272

Member Of
CREDAI
AHILYANAGAR



RERA Registration No.
P52200050501

maharera.mahaonline.gov.in

The Contents of the Brochures are Purely Conceptional & Have No Legal Binding on us.
Developers Reserve the Right to Amend the Layout Plans, no. of Floors, Elevations, Color Scheme & Other Amenities.